

合格证  
QC PASS

Godox

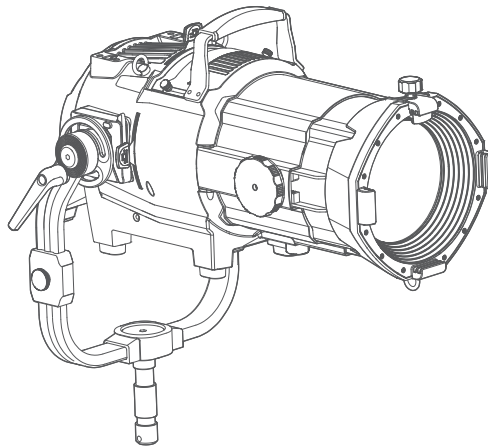

Wechat  
Official Account  
神牛微信公众号

深圳市神牛摄影器材有限公司

地址: 深圳市宝安区福海街道塘尾社区耀川工业区厂房2栋 电话: 0755-29609320(8062)

传真: 0755-25723423 邮箱: godox@godox.com

GODOX Photo Equipment Co., Ltd.

Add.: Building 2, Yaochuan Industrial Zone, Tangwei Community, Fuhai Street, Bao'an District,

Shenzhen 518103, China Tel: +86-755-29609320(8062) Fax: +86-755-25723423

E-mail: godox@godox.com

godox.com

Made in China | 705-GPK000-03



# KNOWLED

## GP19K GP26K

## GP36K

G卡口19°/26°/36°投影筒套装  
Projection Kit with 19°/26°/36° Lens

使用手册  
Instruction Manual

## 前言

感谢您购买神牛产品!

神牛全新推出一系列神牛G卡口投影筒, 一共三款: GP19K、GP26K、GP36K。GP19K内含19°可拆卸镜头, GP26K内含26°可拆卸镜头、GP36K内含36°可拆卸镜头。

GP系列投影筒属于KNOWLED专业级影视控光工具, 搭配神牛G卡口LED摄影灯, 它可以是聚光灯、也可以是追光灯, 还能是投影灯; 能够为用户提供聚光、追光、光束切割、光学变焦、光束投影、光束造型等特色光效。

## 警告

- ▲ 请勿私自拆卸产品, 如产品出现故障须由本公司或授权的维修人员进行检查维修。
- ▲ 本品属于精密光学机械, 请勿让儿童靠近及接触本产品。
- ▲ 注意壳体高温, 点亮时请勿触摸壳体, 以免发生人身伤害。
- ▲ 若发生故障, 请立即关闭电源, 待维修完毕方可重新使用。
- ▲ 请勿放置在超过40度高温环境中。

## 部件名称

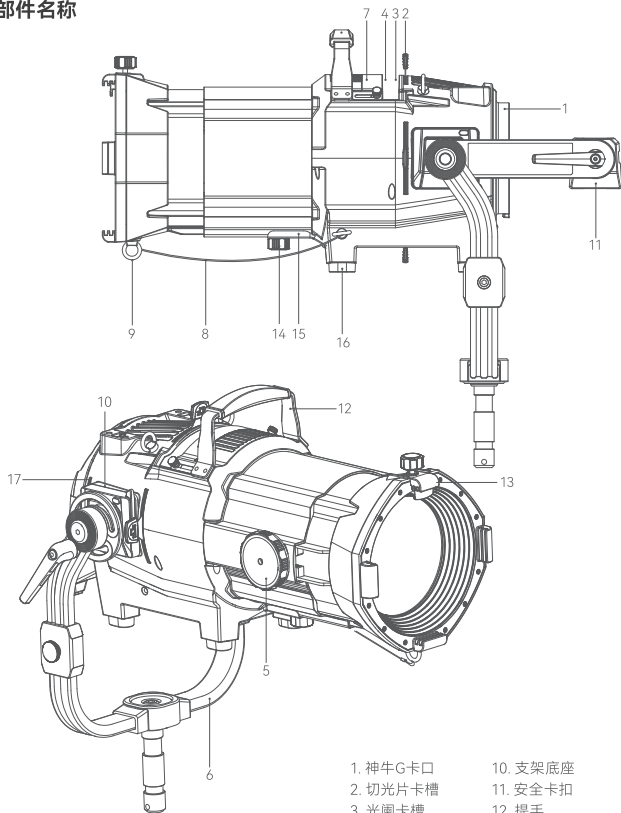

### 安全说明:

1. 投影筒正常使用时, 安全绳挂钩务必扣入镜头扣环, 防止镜头脱落。
2. 投影筒正常使用时, 灯头与投影筒需连接到位, 防止卡口松动并对卡口进行保护。

1. 神牛G卡口
2. 切光片卡槽
3. 光阑卡槽
4. 投影片卡槽
5. 对焦旋钮
6. 支撑支架
7. 光阑槽盖
8. 安全绳
9. 镜头扣环
10. 支架底座
11. 安全卡扣
12. 提手
13. 附件卡扣
14. 镜头固定螺丝
15. 遮光片
16. 橡胶底座
17. 灯头安装指示标

## 物料清单

名称	型号	标配物品
G卡口19°投影筒套装	GP19K	投影筒×1 (含19°规格镜头)、投影片夹×1、投影片组×1、箱包SC07×1、扩散玻璃×1、说明书×1
G卡口26°投影筒套装	GP26K	投影筒×1 (含26°规格镜头)、投影片夹×1、投影片组×1、箱包SC07×1、扩散玻璃×1、说明书×1
G卡口36°投影筒套装	GP36K	投影筒×1 (含36°规格镜头)、投影片夹×1、投影片组×1、箱包SC05×1、扩散玻璃×1、说明书×1

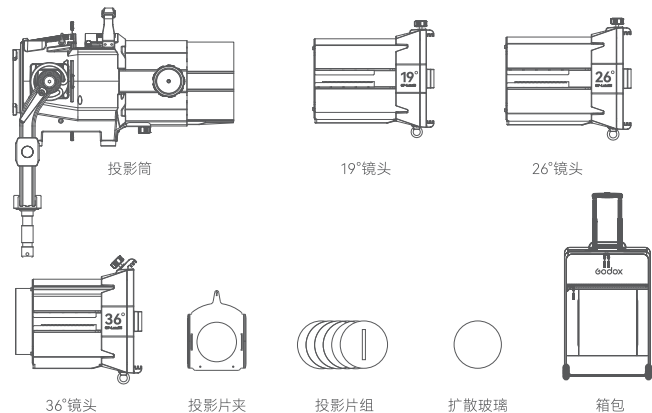

## 可选购附件



投影片组GP-GS1

投影片组GP-GS2

投影片组GP-GS3

投影片组GP-GS4



投影片组GP-GS5



投影片组GP-01

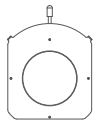

光阑GP-ID

## 安装及其使用

### 1. 安装到三脚架上

将投影筒插入三脚架套筒中，调至所需拍摄角度，最后顺时针旋转套筒固定好投影机。

注：三脚架为另购物品，不包含在套装内。

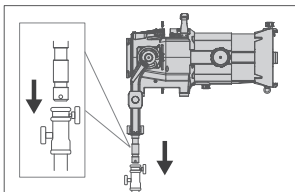

### 2. 安装LED摄影灯 (以MG1200Bi为例)

将LED摄影灯卡口推制对准投影筒的灯头安装指示标插入，顺时针旋转拧紧即可。

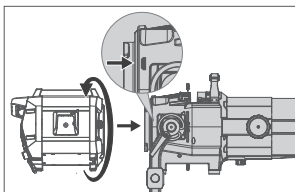

### 3. 拆卸LED摄影灯 (以MG1200Bi为例)

将MG1200Bi卡口推制往后拉伸，接着逆时针旋转松开即可完成拆卸。

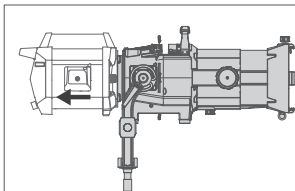

### 4. 安装光阑

先用手拧松光阑槽侧边螺丝，取下光阑槽盖和螺丝，将光阑插入光阑槽即可完成安装。

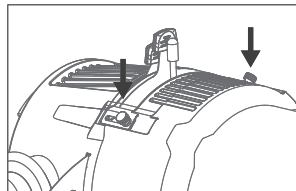

### 5. 安装投影片

将所需的投影片放进投影片夹中，接着将投影片夹放进投影片卡槽，稍微用力往下压，投影片夹完全插入投影片卡槽即表示完成安装。

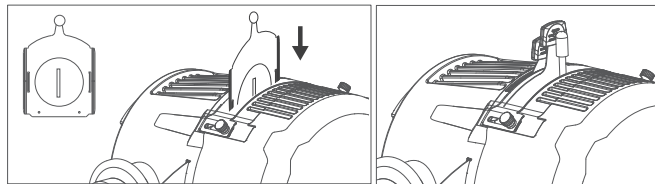

投影筒+19°镜头，搭配LED灯MG1200Bi

色温	测试条件	照度单位	3m	5m	7m	9m
2800K	裸灯	lux	4850	1990	1150	763
		fc	451	185	107	70.8
	19°镜头	lux	34700	10800	5080	3020
		fc	3220	999	472	281
3200K	裸灯	lux	5330	2180	1270	838
		fc	495	202	118	77.9
	19°镜头	lux	38200	11700	5610	3300
		fc	3550	1090	521	307
4300K	裸灯	lux	5990	2470	1420	942
		fc	557	229	132	87.5
	19°镜头	lux	43900	13400	6440	3790
		fc	4080	1250	598	352
5600K	裸灯	lux	6290	2590	1490	994
		fc	585	240	138	92.4
	19°镜头	lux	46100	14100	6780	4010
		fc	4290	1310	630	372
6500K	裸灯	lux	6250	2580	1480	990
		fc	580	240	138	92
	19°镜头	lux	46300	14200	6810	4020
		fc	4300	1320	633	374

### 投影筒+26°镜头, 搭配LED灯MG1200Bi

色温	测试条件	照度单位	3m	5m	7m	9m
2800K	裸灯	lux	4850	1990	1150	763
		fc	451	185	107	70.8
	26°镜头	lux	18200	5880	2910	1750
		fc	1690	546	270	162
3200K	裸灯	lux	5330	2180	1270	838
		fc	495	202	118	77.9
	26°镜头	lux	20000	6470	3210	1920
		fc	1860	601	298	179
4300K	裸灯	lux	5990	2470	1420	942
		fc	557	229	132	87.5
	26°镜头	lux	22800	7420	3680	2810
		fc	2120	690	342	205
5600K	裸灯	lux	6290	2590	1490	994
		fc	585	240	138	92.4
	26°镜头	lux	24000	7840	3890	2330
		fc	2230	728	361	217
6500K	裸灯	lux	6250	2580	1480	990
		fc	580	240	138	92
	26°镜头	lux	24200	7880	3910	2350
		fc	2250	732	363	218

### 投影筒+36°镜头, 搭配LED灯MG1200Bi

色温	测试条件	照度单位	3m	5m	7m	9m
2800K	裸灯	lux	4850	1990	1150	763
		fc	451	185	107	70.8
	36°镜头	lux	15100	5020	2540	1540
		fc	1400	466	236	143
3200K	裸灯	lux	5330	2180	1270	838
		fc	495	202	118	77.9
	36°镜头	lux	16600	5540	2790	1690
		fc	1550	514	259	157
4300K	裸灯	lux	5990	2470	1420	942
		fc	557	229	132	87.5
	36°镜头	lux	19000	6330	3200	1950
		fc	1770	588	297	181
5600K	裸灯	lux	6290	2590	1490	994
		fc	585	240	138	92.4
	36°镜头	lux	20100	6660	3360	2050
		fc	1860	619	312	190
6500K	裸灯	lux	6250	2580	1480	990
		fc	580	240	138	92
	36°镜头	lux	20200	6700	3380	2060
		fc	1870	623	314	191

以上测试皆在灯体100%亮度且投影筒设为聚光状态下进行。

### 尺寸信息

投影筒 (含镜头)	418mm*647mm*727mm
19°镜头	281mm*235mm*289mm
26°镜头	281mm*235mm*289mm
36°镜头	281mm*234mm*287mm

### 重量信息

投影筒 (不含镜头)	≈11.6kg
19°镜头	≈9.94kg
26°镜头	≈8.41kg
36°镜头	≈8.23kg

### 不同镜头光斑均匀度

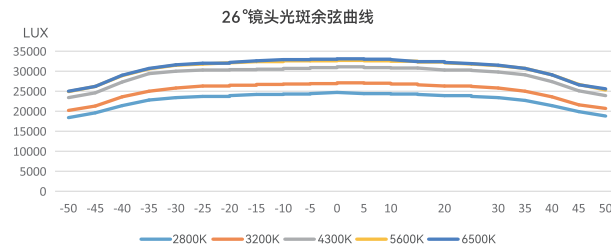
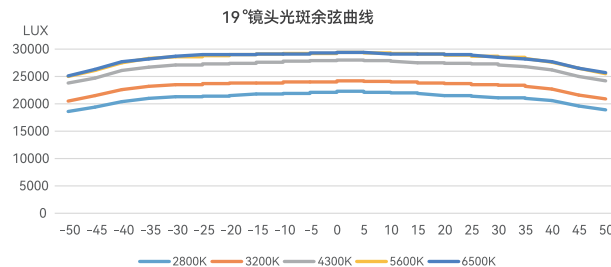

36°镜头光斑余弦曲线

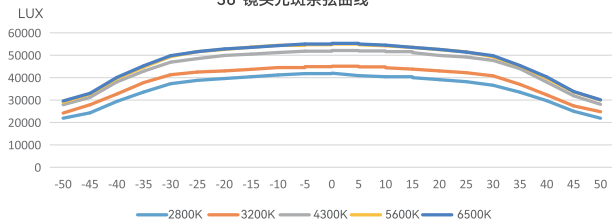

三个镜头所测光斑直径为1m

以上数据均为平均值，非绝对值，测试皆在灯体MG1200Bi 100%亮度下进行。

## 更换镜头说明

- 待投影筒冷却后，使用扳手将镜头上面的9颗螺丝逆时针旋转取下；

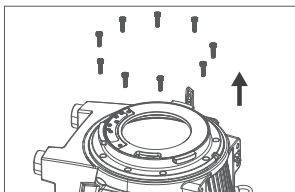

- 戴上手套，将镜头从投影筒上取出。

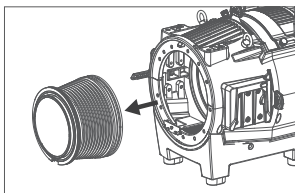

- 将橙色一面放在底下，使用镜头扳手卡住镜头两侧卡位，随即逆时针旋转直至可将镜头上的圆环取下；

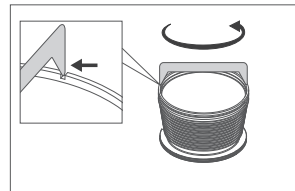

- 然后——将外环、①号凸透镜、②号磨砂平面镜+细环、③号凸透镜+粗环（凸面比①号要凸）取出，此时可根据实际使用状况，更换对应的镜片。

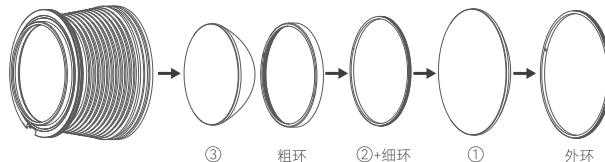

- 替换上对应的镜片后，将③号凸透镜、粗环、②号磨砂平面镜+细环、①号凸透镜、外环按照顺序放入筒中，牢记③号和①号凸透镜放入时要求凸面是上面，②号磨砂平面镜放入时要求磨砂面朝上。

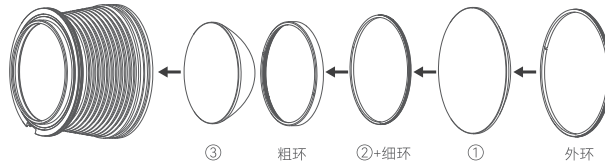

6. 接着放上圆环后, 将镜头扳手卡住镜头两侧卡位, 顺时针旋转直至旋紧;

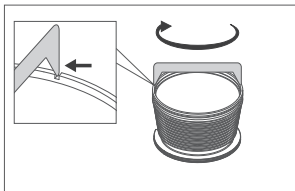

7. 将镜头放入投影筒中, 使用扳手将镜头上面的9颗螺丝顺时针旋转拧紧即可更换镜头完毕。

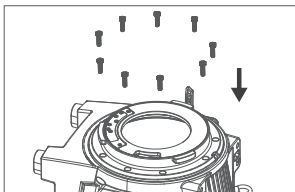

## Foreword

Thank you for purchasing!

Godox is launching a new series of Godox G-mount projection kits, which are GP19K, GP26K and GP36K. GP19K has a 19° detachable lens, GP26K has a 26° detachable lens, and GP36K has a 36° detachable lens.

GP series projection attachments are KNOWLED professional-grade film and television light control tools. When collocated with the Godox G-mount LED light, it can be spotlight, chase light, or projection light, providing users with spotlight, chase light, beam cutting, optical zoom, beam projection, beam modeling and other special light effects.

## Warning

- ▲ Do not disassemble. Should repairs become necessary, this product must be sent to our company or an authorized maintenance center.
- ▲ This is a precision optical instrument, keep out of reach of children.
- ▲ Watch out for high temperature, do not touch when the light is on.
- ▲ In the event of malfunction, do not use until professional repair.
- ▲ Do not leave or store the product in the temperature over 40°C.

## Name of Parts

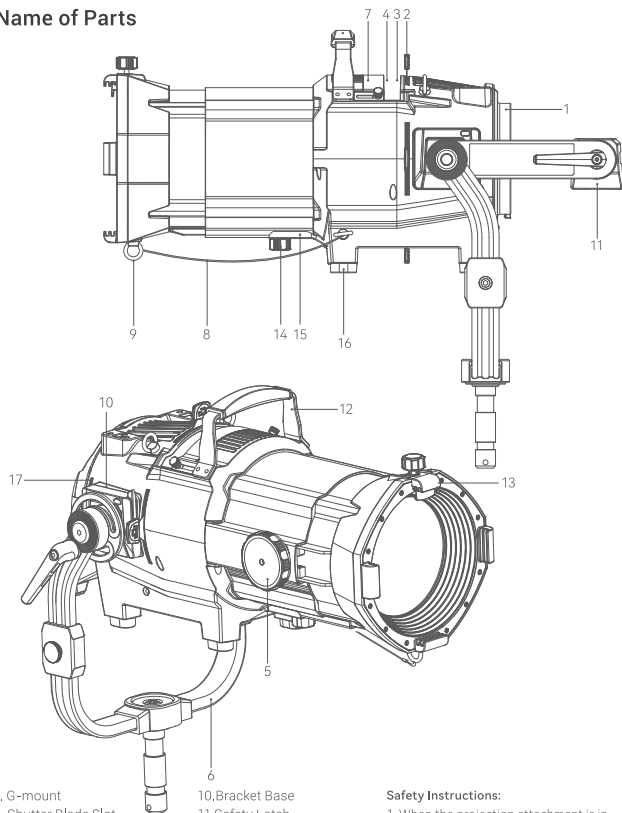

1. G-mount
2. Shutter Blade Slot
3. Iris Diaphragm Slot
4. Gobo Holder Slot
5. Focusing Dial
6. U-bracket
7. Iris Diaphragm Cap
8. Safety Rope
9. Lens Locking Ring
10. Bracket Base
11. Safety Latch
12. Handle
13. Attachment Latch
14. Lens Fixation Screw
15. Light Shield
16. Rubber Base
17. Lamp Installation Instruction Label

### Safety Instructions:

1. When the projection attachment is in normal use, the safety rope hook must be attached to the lens locking ring to prevent the lens from falling.
2. When the projection attachment is in normal use, the lamp head and projection attachment must be connected to prevent the mount from loosening and to protect the mount in the meantime.

## Packing List

Name	Model	What's in the Box
Projection Kit with 19° Lens	GP19K	Projection Attachment×1 (including a Projection Lens 19°) 、 Gobo Holder×1, Gobo Set×1, Portable BagSC07×1, Ground Glass Diffuser x1, Instruction Manual×1
Projection Kit with 26° Lens	GP26K	Projection Attachment×1 (including a Projection Lens 26°) 、 Gobo Holder×1, Gobo Set×1, Portable BagSC07×1, Ground Glass Diffuser x1, Instruction Manual×1
Projection Kit with 36° Lens	GP36K	Projection Attachment×1 (including a Projection Lens 36°) 、 Gobo Holder×1, Gobo Set×1, Portable BagSC05×1, Ground Glass Diffuser x1, Instruction Manual×1

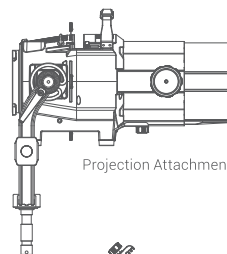

Projection Attachment

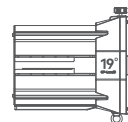

Projection Lens 19°

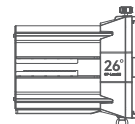

Projection Lens 26°

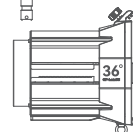

Projection Lens 36°

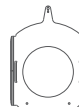

Gobo Holder



Gobo Set



Ground Glass Diffuser



Portable Bag

## Optional Accessories



GOGO Set for GP-GS1

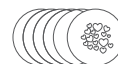

GOGO Set for GP-GS2

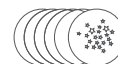

GOGO Set for GP-GS3

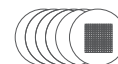

GOGO Set for GP-GS4



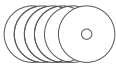

GOGO Set for GP-GS5



GOGO Set for GP-01

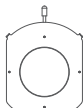

Iris Diaphragm GP-ID

## Installation and Application

### 1. Mounted on the tripod

Insert the projection attachment into the sleeve of the tripod, adjust to the proper angle, then turn the sleeve clockwise to tighten and secure.

Note: Tripod is sold separately.

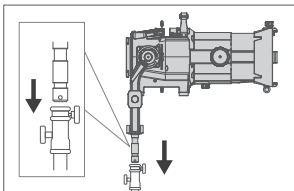

### 2. Installation of LED Light

(Take MG1200Bi as an example)

Align the LED light mount locking pusher with the lamp installation instruction label on the projection attachment and insert it. Rotate clockwise and tighten to secure.

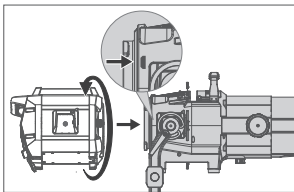

### 3. Disassembly of LED Light

(Take MG1200Bi as an example)

Pull the MG1200Bi pusher backward, then turn it counterclockwise to release it.

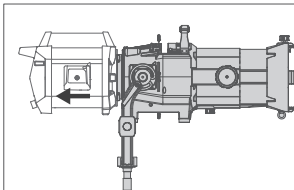

### 4. Installation of Iris Diaphragm

Loosen the screw beside the iris diaphragm slot with hands, remove the iris diaphragm cap and the screw, and then insert the iris diaphragm into iris diaphragm slot.

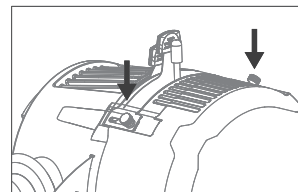

### 5. Installation of Gobo

Place the Gobo in the Gobo holder, then insert the Gobo holder into the slot, pressing down slightly until it is fully inserted.

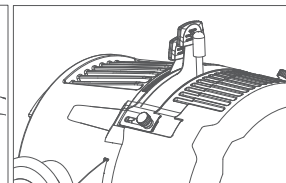
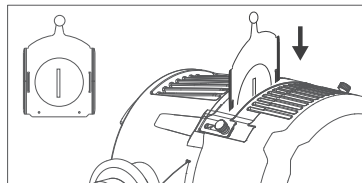

### Projection Attachment + 19° Lens, paired with MG1200Bi LED light

CCT	Testing Condition	Unit	3m	5m	7m	9m
2800K	Bare light	lux	4850	1990	1150	763
		fc	451	185	107	70.8
	19° Lens	lux	34700	10800	5080	3020
		fc	3220	999	472	281
3200K	Bare light	lux	5330	2180	1270	838
		fc	495	202	118	77.9
	19° Lens	lux	38200	11700	5610	3300
		fc	3550	1090	521	307
4300K	Bare light	lux	5990	2470	1420	942
		fc	557	229	132	87.5
	19° Lens	lux	43900	13400	6440	3790
		fc	4080	1250	598	352
5600K	Bare light	lux	6290	2590	1490	994
		fc	585	240	138	92.4
	19° Lens	lux	46100	14100	6780	4010
		fc	4290	1310	630	372
6500K	Bare light	lux	6250	2580	1480	990
		fc	580	240	138	92
	19° Lens	lux	46300	14200	6810	4020
		fc	4300	1320	633	374

### Projection Attachment + 26° Lens, paired with MG1200Bi LED light

CCT	Testing Condition	Unit	3m	5m	7m	9m
2800K	Bare light	lux	4850	1990	1150	763
		fc	451	185	107	70.8
	26° Lens	lux	18200	5880	2910	1750
		fc	1690	546	270	162
3200K	Bare light	lux	5330	2180	1270	838
		fc	495	202	118	77.9
	26° Lens	lux	20000	6470	3210	1930
		fc	1860	601	298	179
4300K	Bare light	lux	5990	2470	1420	942
		fc	557	229	132	87.5
	26° Lens	lux	22800	7420	3680	2180
		fc	2120	690	342	205
5600K	Bare light	lux	6290	2590	1490	994
		fc	585	240	138	92.4
	26° Lens	lux	24000	7840	3890	2330
		fc	2230	728	361	217
6500K	Bare light	lux	6250	2580	1480	990
		fc	580	240	138	92
	26° Lens	lux	24200	7880	3910	2350
		fc	2250	732	363	218

### Projection Attachment + 36° Lens, paired with MG1200Bi LED light

CCT	Testing Condition	Unit	3m	5m	7m	9m
2800K	Bare light	lux	4850	1990	1150	763
		fc	451	185	107	70.8
	36° Lens	lux	15100	5020	2540	1540
		fc	1400	466	236	143
3200K	Bare light	lux	5330	2180	1270	838
		fc	495	202	118	77.9
	36° Lens	lux	16600	5540	2790	1690
		fc	1550	514	259	157
4300K	Bare light	lux	5990	2470	1420	942
		fc	557	229	132	87.5
	36° Lens	lux	18800	6270	3160	1920
		fc	1740	582	294	177
5600K	Bare light	lux	6290	2590	1490	994
		fc	585	240	138	92.4
	36° Lens	lux	20100	6660	3360	2050
		fc	1860	619	312	190
6500K	Bare light	lux	6250	2580	1480	990
		fc	580	240	138	92
	36° Lens	lux	20200	6700	3380	2060
		fc	1870	623	314	191

The above tests were carried out with the luminaire set to 100% brightness and the projection attachment set to spotlight.

### Dimension

Projection attachment (including lens)	418mm+647mm+727mm
Projection attachment Lens 19°	281mm+235mm+289mm
Projection attachment Lens 26°	281mm+235mm+289mm
Projection attachment Lens 36°	281mm+234mm+287mm

### Weight

Projection attachment (excluding lens)	≈11.6kg
Projection attachment Lens 19°	≈9.94kg
Projection attachment Lens 26°	≈8.41kg
Projection attachment Lens 36°	≈8.23kg

## Beam uniformity of different lens

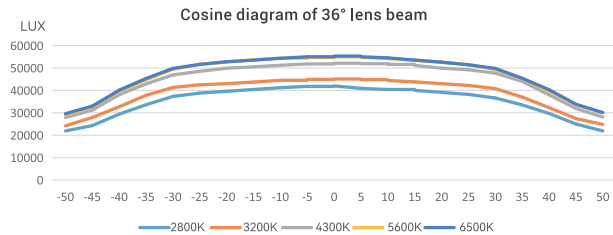
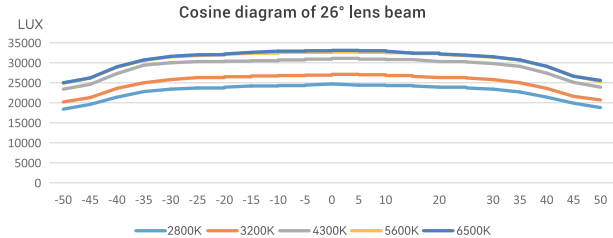
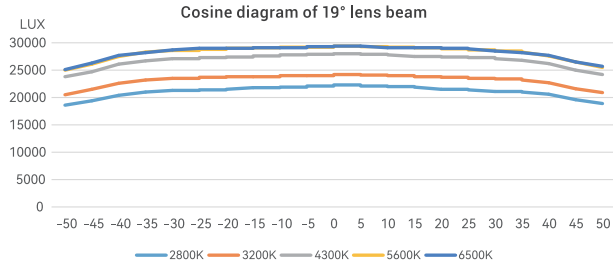

The diameter of the light spot measured by the three lenses is 1 meter.  
The above data are averages, not absolute values. The tests were conducted with the MG1200Bi light body at 100% brightness.

## Lens Replacement Instructions:

1. After the projection attachment has cooled down, use a wrench to rotate the 9 screws on the top of the lens counterclockwise to remove them.

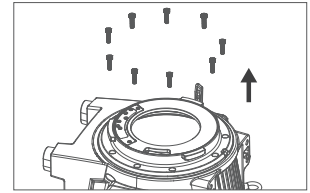

2. Put on gloves and remove the lens from the projection attachment.

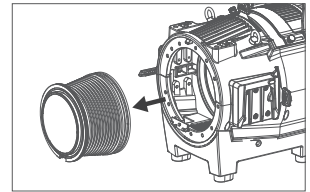

3. Placing the orange side facing downwards, use the lens wrench to grip the lens on both sides and rotate counterclockwise until the ring on the lens can be removed.

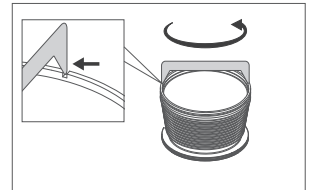

4. Then, one by one, remove the outer ring, No. 1 convex lens, No. 2 matte flat lens + thin ring, and No. 3 convex lens + thick ring (the convex surface of No. 3 is more convex than No. 1), according to the actual usage, replace the corresponding lens.

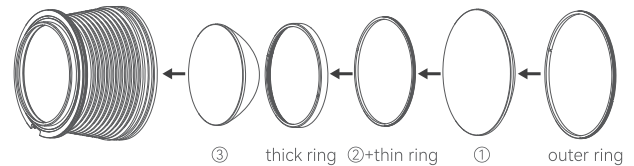

5. After replacing the corresponding lens, place No. 3 convex lens + thick ring, No. 2 matte flat lens + thin ring, and No. 1 convex lens outer ring in the projection attachment in order. Remember that the convex surface of No. 3 and No. 1 should be facing upwards, and the matte surface of No. 2 should be facing upwards.

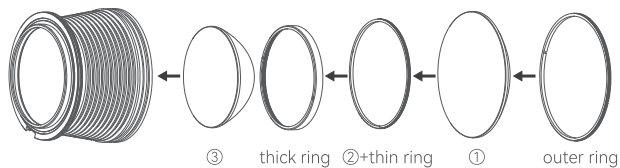

6. Then, put the ring back on and use the wrench to grip the lens on both sides and rotate clockwise until it is securely tightened.

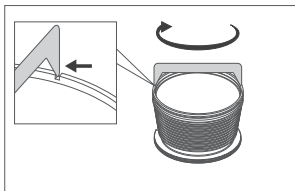

7. Place the lens back into the projection attachment and use the wrench to rotate the 9 screws on the top of the lens clockwise to tighten them, and you are done.

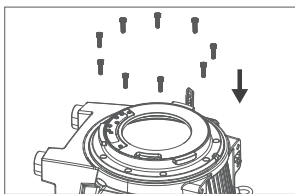

## 产品保修

尊敬的用户, 本保修卡是申请保修服务的重要凭证, 请您配合销售商填写并妥善保管, 谢谢!

产品信息	型号	产品条码
用户信息	姓名	联系电话
	通信地址	
销售商信息	名称	
	联系电话	
	通信地址	
	销售日期	
备注		

注: 此表应由销售商盖章确认。

### 产品信息

本文件适用于相关《产品保修信息》(见后面说明)所列产品, 其他非属此范围的产品或部件(如促销品、赠品及其他出厂后附加的部件等)不在此保修承诺内。

### 保修期

产品及部件的相应保修期按相关的《产品保修信息》执行。保修期自产品首次购买日起算, 购买日以购买产品时保修卡登记日期为准。

### 如何获得保修服务

您可直接与产品销售商或授权服务机构联系, 也可拨打神牛产品售后服务电话, 与我们联系, 由我们的服务人员为您安排服务。申请保修时, 您应提供有效的保修卡作为保修凭证, 方可获得保修。如您不能提供有效的保修卡, 则在我们确认产品或部件属于保修范围的情况下, 也可以为您提供保修, 但这不作为我们的义务。

### 不适用保修的情况

如产品存在下列情况, 本文件项下的保证和服务将不适用: ①产品或部件超过相应保修期; ②错误或不适当使用、维护或 保管导致的故障或损坏, 如: 不当搬运; 非按产品合理预期用途使用; 不当插拔外接设备; 跌落或外力挤压; 接触或暴露于不适当温度、溶剂、酸碱、水浸或潮湿环境; ③由非神牛授权机构或人员安装、修理、更改、添加或拆卸造成的故障或损坏; ④产品或部件原有识别信息被修改变更或删除; ⑤无有效保修卡; ⑥使用非法授权、非标准或非公开发行的软件造成的故障或损坏; ⑦因不可抗力或意外事件造成的故障或损坏; ⑧其他非因产品本身质量问题导致的故障或损坏。遇上述情况, 您应向相关责任方寻求解决, 神牛对此不承担任何责任。因非在保修期或保修范围内的部件、附件或软件导致产品不能正常使用的, 不是保修范围内的故障。产品使用过程中正常的脱色, 磨损和消耗, 不是保修范围内的故障。

## 产品保修和服务支持信息

产品的保修期和服务类型按以下《产品保修信息》执行:

产品类别	选件名称	保修期(月)	保修服务类型
部件	主机	12	客户送修
	电池	3	客户送修
	充电器等带电性能的部件。	12	客户送修
其他	如电源线、同步线闪光灯、造型灯泡、外壳、保护罩、锁紧装置、包装等。	无	无保修

神牛产品售后服务电话 0755-29609320-8062

## Warranty

Dear customers, as this warranty card is an important certificate to apply for our maintenance service, please fill in the following form in coordination with the seller and safe-keep it. Thank you!

Product Information	Model	Product Code Number
Customer Information	Name	Contact Number
	Address	
Seller Information	Name	
	Contact Number	
	Address	
	Date of Sale	
Note		

Note: This form shall be sealed by the seller.

### Applicable Products

The document applies to the products listed on the Product Maintenance Information (see below for further information). Other products or accessories (e.g. promotional items, giveaways and additional accessories attached, etc.) are not included in this warranty scope.

### Warranty Period

The warranty period of products and accessories is implemented according to the relevant Product Maintenance Information. The warranty period is calculated from the day (purchase date) when the product is bought for the first time. And the purchase date is considered as the date registered on the warranty card when buying the product.

### How to Get the Maintenance Service

If maintenance service is needed, you can directly contact the product distributor or authorized service institutions. You can also contact the Godox after-sale service call and we will offer you service. When applying for maintenance service, you should provide valid warranty card. If you cannot provide valid warranty card, we may offer you maintenance service once confirmed that the product or accessory is involved in the maintenance scope, but that shall not be considered as our obligation.

### Inapplicable Cases

The guarantee and service offered by this document are not applicable in the following cases: ① The product or accessory has expired its warranty period; ② Breakage or damage caused by inappropriate usage, maintenance or preservation, such as improper packing, improper usage, improper plugging in/out external equipment, falling off or squeezing by external force, contacting or exposing to the improper temperature, solvent, acid, base, flooding and damp environments, etc; ③ Breakage or damage caused by non-authorized institution or staff in the process of installation, maintenance, alteration, addition and detachment; ④ The original identifying information of product or accessory is modified, alternated, or removed; ⑤ No valid warranty card; ⑥ Breakage or damage caused by using illegally authorized, nonstandard or non-public released software; ⑦ Breakage or damage caused by force majeure or accident; ⑧ Breakage or damage that could not be attributed to the product itself. Once met these situations above, you should seek solutions from the related responsible parties and Godox

assumes no responsibility. The damage caused by parts, accessories and software that beyond the warranty period or scope is not included in our maintenance scope. The normal discoloration, abrasion and consumption are not the breakage within the maintenance scope.

## Maintenance and Service Support Information

The warranty period and service types of products are implemented according to the following Product Maintenance Information:

Product Type	Name	Maintenance Period(month)	Warranty Service Type
Parts	Circuit Board	12	Customer sends the product to designated site
	Battery	3	Customer sends the product to designated site
	Electrical parts e.g,battery charger, etc.	12	Customer sends the product to designated site
Other Items	Flash tube, power cord, sync cable,modeling lamp,lamp body, lamp cover,lockingdevice, package, etc.	No	Without warranty

Godox After-sale Service Call +86-755-29609320(8062)